

APPLICATION

A decorative cylinder for surface mount is ideal for applications that require long lamp life and energy saving benefits of LED technology.

PRODUCT DATA

REFLECTOR: Reflector features regressed lens for softly diffused illumination.

HOUSING: The cylindrical housing is heavy gauge aluminum and finished to an architectural grade. The standard exterior finish is matte white, powder coat paint.

ELECTRICAL: 120 to 277 VAC, 50-60 Hz.

LED MODULE: Bridgelux Vero 18 LED module. CRI = 80. Available in 90 CRI.

- Expected lamp life to be 50,000 hours with 70% lumen maintenance when ambient temperatures do not exceed 35°C. Lower ambient temperatures yield longer lamp life.

HEAT MANAGEMENT: Engineered heat sink provides passive cooling for optimum heat management of LED engine.

DIMMING: 0-10V dimming, specify DA.

MOUNTING:

Ceiling (Surface) Mount – Provided with mounting holes for securement to 4" octagon junction box.

CALIBER

COMMERCIAL

SERIES C4SLB78V LED Cylinder
Downlight 982 - 2749 Lumen

**5 Year
Warranty**

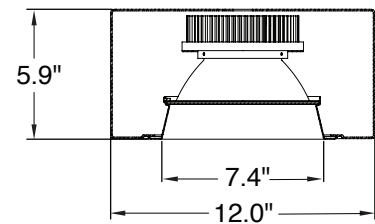

Intertek

Damp Location

Catalog #:

C4

Example: C4SLB78V2035KDA

C4LBVFAL

Example: C4LBVFALHAZPF

Fixture Series	Lumens	Color Temp.	Dimming	Options
Surface – C4SLB78V	10 (982L, 10W)	5K (5000K)	DA = Xitanium 1% 0-10V (linear) is standard. <i>More options on next page.</i>	#-F = Fuse and Fuse Holder Emergency Battery Pack not available
	20 (1845L, 20W)	4K (4000K)		
	30 (2749L, 30W)	35K (3500K)		
	C9 90 CRI	3K (3000K)		
		27K (2700K)		

Trim	Trim Finish
C4LBVFAL - Reflector with Regressed Frosted Acrylic Lens	
	SCLPF – Soft Specular Clear Alzak with Polished Flange
	HAZPF – Haze Matte Alzak with Polished Flange
<i>For other finishes, consult reflector section.</i>	

Optional Finishes **Suffix #** **Suffix #**

- | | |
|--|---|
| <input type="checkbox"/> Black Cylinder Housing – B | <input type="checkbox"/> Satin Aluminum Housing – SA |
| <input type="checkbox"/> Bronze Cylinder Housing – Z | <input type="checkbox"/> Metallic Aluminum Housing.... – MA |
| <input type="checkbox"/> Galvanite Housing – GAL | |

Manufactured and tested to UL#1598 and CSA standards.

Note: Suitable for damp location.

All Pathway® products meet or exceed requirements as established by the National Electrical Code. Specifications subject to change without notice.

Alzak® is a registered trademark of Alcoa.

Fixture:	Type:
Project:	

PATHWAY
LIGHTING

Pathway Lighting Products, Inc., P.O. Box 591, Old Saybrook, CT 06475-0591
voice 800.342.0592 • fax 800.207.0090 • www.pathwaylighting.com • e-mail: sales@pathwaylighting.com

LCBV2.1
CRBUUN

Dimming Options:

Specify option by suffix (shown in bold-face type)

Our White Paper regarding Linear vs. Logarithmic Operating Characteristics is available in our 'Downloads' section of our website, or you may request one by emailing Sales@PathwayLighting.com

0-10V Dimming Options	Lutron Dimming Options	DALI Dimming Options	Foward/Reverse Phase Options
DA = Xitanium 1% 0-10V (linear) DB = Xitanium 1% 0-10V (logarithmic) DC = EldoLED 0-10V 0% (logarithmic) DD = EldoLED 0-10V 1% (logarithmic) DE = EldoLED 0-10V 0% (linear) DF = EldoLED 0-10V 1% (linear)	Maximum Lumen Designation of 50 DG = Lutron Eco 1% (linear) DH = Lutron 3 wire 1% (linear) DJ = Lutron 2 wire 1% (linear)	DK = EldoLED DALI 0% (logarithmic) DL = EldoLED DALI 1% (logarithmic)	DM = 120V Forward/Reverse Phase 1% (linear)

Delivered Lumen Data (3500K Color Temperature)

FIXTURE	TRIM	LENS TYPE	WATTAGE	DELIVERED LUMENS	BEAM DISTRIBUTION	LPW
C4SLB78V1035K	C4LBVFALSCLPF	Frosted	9	982	70°	98.20
C4SLB78V2035K	C4LBVFALSCLPF	Frosted	19	1845	70°	92.25
C4SLB78V2035K	C4LBVFALSCLPF	Frosted	30	2749	70°	91.63

Above values reflect 3500K color temperatures.

Scaling factors for other color temperatures: 2700K = .92; 3000K = .97; 4000K = 1.01; 5000K = 1.04

Scaling for 90 CRI = 0.83